

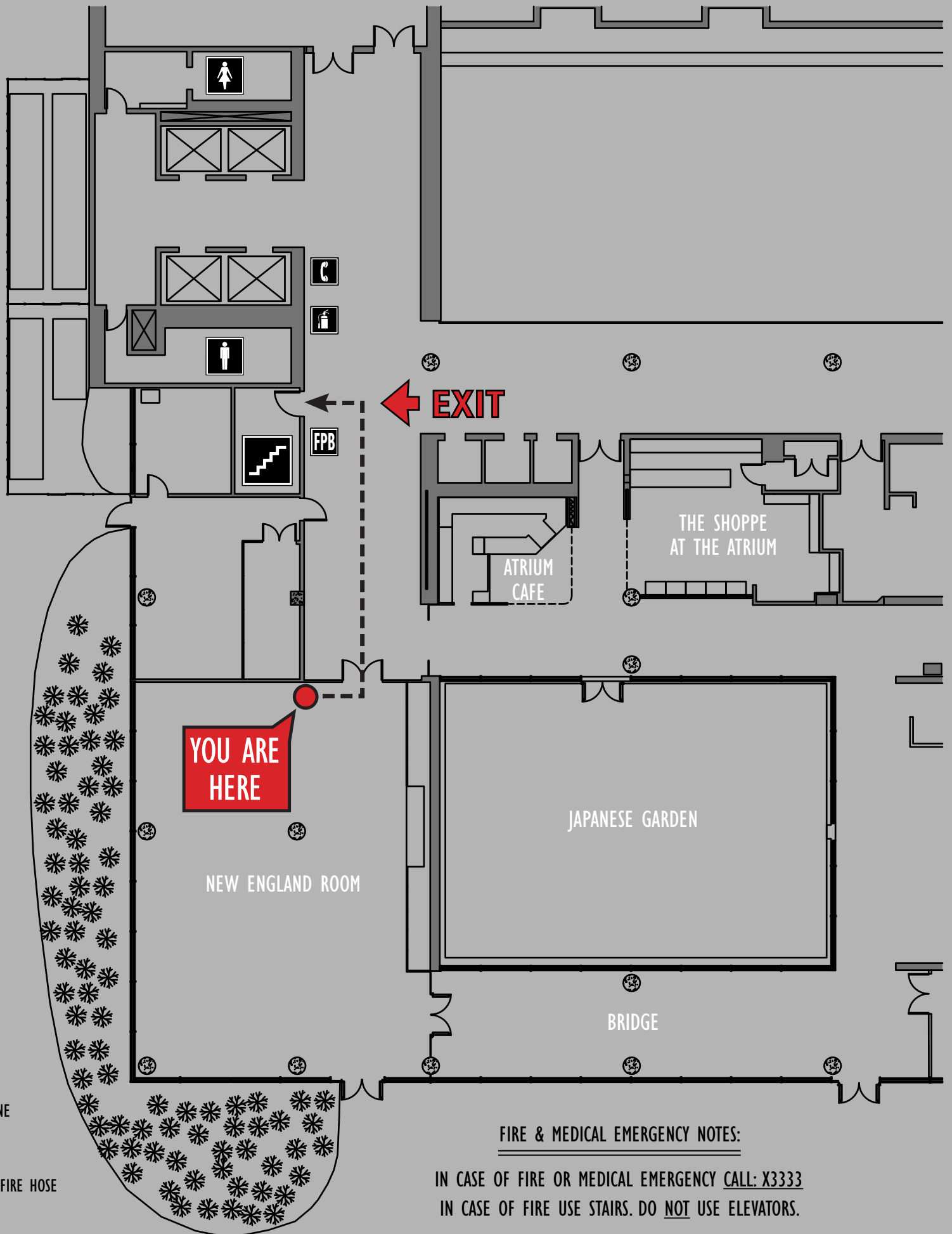



EVACUATION ROUTES



LEGEND:

-  EMERGENCY PHONE
-  EXIT STAIRWELL
-  EXTINGUISHER & FIRE HOSE
-  FIRE PULL BOX

FIRE & MEDICAL EMERGENCY NOTES:

IN CASE OF FIRE OR MEDICAL EMERGENCY CALL: X3333
IN CASE OF FIRE USE STAIRS. DO NOT USE ELEVATORS.

NEW ENGLAND ROOM / H-4